

BRITESTREAM

SLIM90 FIBREGLASS NICHE LED LIGHT

The Britestream Slim90 Fibreglass Niche LED light has been specifically designed for easy installation into fibreglass pools & spas.

Britestream Slim90 Fibreglass Niche LED lights are great for those hard to light areas of a pool/spa or steps.

Britestream Slim90 Fibreglass LED Light utilises energy efficient super bright LED's and operates on only 15 watts of energy.

- Flush mounted with a minimal 14mm projection into pool.
- Super bright LED's capable of delivering 128 lumens (White LED).
- Life span of over 70,000 hours.
- 180° Zonal illumination.
- Operates on only 15% of the electrical power of a halogen light models.
- Available in Blue & White.



Durable Niche Housing

Niche housing is constructed from injection moulded ABS for non-corrosive durability.



Simple Maintenance

Easy to remove 1/4 turn all in one lens and LED's.

Innovative Lens

Its innovative polycarbonate lens protects the LED's and provides a uniform diffusion of light.

Technical Specifications

Zonal Distribution	Power Usage	Input Voltage	LED Life
0 to 180 degrees	15Watt	12V AC	70,000 hours

Dimension

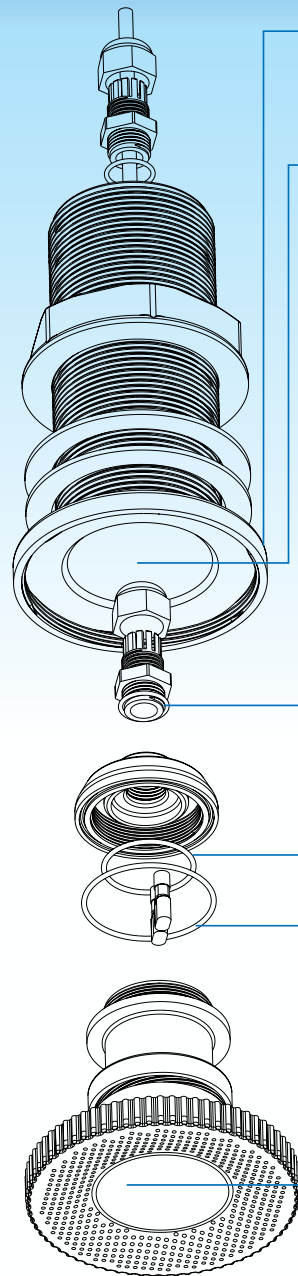
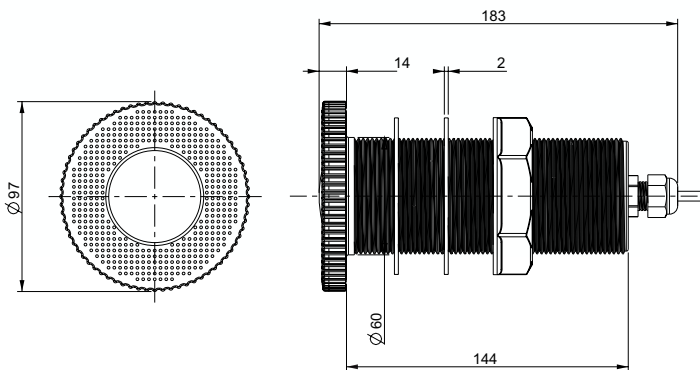

Extra Slim Protrusion

Projects only 14mm from the pool/spa wall.

Easy Coiling

Extra space for easy coiling and storage of the light's power cord.

Triple seal connection

Three O'rings are in place to provide a triple seal eliminating the possibility of any leakages travelling up the power cord.

Precision Built

Britestream Slim90 comprises of a precision built printed circuit board totally enclosed in a waterproof housing.

Super Bright

Super bright energy saving LED's.

Long Life

Britestream Slim90 LED has a life span of over 70 000 hours, which is equivalent to over 30 years of illumination. (Based on 6 hours usage per day).

Built-in Heat Management

The LED's heat output is automatically managed by its electronic circuitry.

Warranty

Britestream Slim90 LED lights are covered by a comprehensive 2 year warranty.

OFFICES - AUSTRALIA

NSW - Sydney (Head Office)
Tel: +61 2 9898 8600

QLD - Brisbane
Tel: +61 7 3299 9900

VIC/TAS - Melbourne
Tel: +61 3 9764 1211

WA - Perth
Tel: +61 8 9273 1900

SA/NT - Adelaide
Tel: +61 8 8244 6000

ACT Distribution
Tel: +61 2 6280 6476

OFFICES - OVERSEAS

Waterco (Europe) Limited
Sittingbourne, Kent, UK
Tel: +44 (0) 1795 521 733

Waterco (USA) Inc
Augusta, Georgia, USA
Tel: +1 706 793 7291

Waterco Canada
Longueuil, Quebec, Canada
Tel: +1 450 748 1421

Waterco (NZ) Limited
Auckland, New Zealand
Tel: +64 9 525 7570

Waterco (C) Limited
Guangzhou, China
Tel: +86 20 3222 2180

Waterco (Far East) Sdn Bhd
Selangor, Malaysia
Tel: +60 3 6145 6000

PT Waterco Indonesia
Jakarta, Indonesia
Tel: +62 21 4585 1481

Waterco Singapore Intl Pte Ltd
Nehsons Building, Singapore
Tel: +65 6344 2378

Waterco France
SAINT PRIEST, France.
Tel: +33 4 72 79 33 30

DISTRIBUTED BY:

WATERCO
water, the liquid of life

